



# STATE OF THE ARTS IN BOSTON

CASE FOR SUPPORT 2020-21

NEMPAC |     
North End Music & Performing Arts Center

## THE ARTS:

Soul to the universe

Wings to the mind

Flight to the imagination

Life to everything

—PLATO

# STATE OF THE ARTS



At NEMPAC, we boldly embrace and embody this vision of the arts.

We believe downtown Boston and its citizens deserve abundant opportunities for communities to learn, engage, and flourish through the arts.

As we look around our Boston neighborhoods and institutions, we see the arts trying to maintain a foothold. Schools battle to preserve their arts education programs. Theaters struggle to stay afloat. Performance spaces shutter their doors. Artists and arts organizations scrape together resources to keep going.

Because of the support of people like you, NEMPAC has been bringing top-quality music education and inspirational professional performances to our neighborhoods for 18 years. Our waitlists are long, and our space is packed beyond capacity. But our ideas for rich programming are limitless, and our opportunity is now.

**It's time to grow.**

**Join us.**

# SET THE SCENE

Inhabiting a mere 570 square feet in our existing Prado Studios, NEMPAC has achieved remarkable impact. We have become masters of doing much with little.

But we have audacious dreams. We envision vibrant Boston neighborhoods where music and performing arts fill the streets with creativity, spark connections, and inspire us to be our best selves.

Thanks to a generous gift from the City of Boston—the building at 48-50 Tileston Street—we will soon be one step closer to realizing those dreams.

This steppingstone phase will enable NEMPAC to ramp up our instructional, performance, and administrative capacity in multiple Boston neighborhoods, soon placing us in a strong position to take advantage of the next growth opportunity to present itself.

**6**  
local school partners

**13**  
community partners

**1,100+**  
students per week  
receive free, in-school  
music education

**18**  
free and discounted  
community concerts  
and local events

**7**  
ticketed professional  
concerts



## ANNUAL IMPACT

**4,500+**  
audience members  
enlightened

**1,450**  
students served

**95**  
professional artistic  
opportunities



## SCHOOL ARTS PARTNERSHIPS

**36%**  
less expensive than  
average Boston rate  
for 30-minute private  
music lessons



## AFFORDABLE ARTS PROGRAMMING

**500+**  
students per week  
receive discounted  
class fees

**\$14,000**  
in music scholarships



## PROFESSIONAL ARTS PROGRAMMING

**45**  
students enroll in free  
performance-based  
youth choir



## ARTS FACULTY

**34**  
teaching artists  
and educators



# WAITING IN THE WINGS

No other arts organization in New England simultaneously operates arts education and professional performing arts programming the way we do, especially during a global pandemic.

The Next Act Campaign will allow NEMPAC to have space for our administrative and instructional programming, with additional resources for enhanced professional programming and an eye toward acquiring a performance space in downtown Boston.



## TILESTON MUSIC CENTER

Imagine transforming 48-50 Tileston Street, a 2,200 square foot building nestled in historic North End and just steps from the Prado Studios, into a state-of-the-art instructional arts facility. With soundproofed studios, dedicated one-on-one lesson space, a beautiful community gathering space, and large classrooms for group instruction, NEMPAC will reach new heights.

As the building transforms, so too will our surrounding communities. More than tripling NEMPAC's space in downtown Boston for music and performing arts will allow more students, old and young, to learn the joys of playing an instrument, create music and lyrics through songwriting, use technology for recording music, rehearse for theatrical performances, and explore rhythm through creative movement.

## PROFESSIONAL PROGRAMMING ENHANCEMENT

Not only will the space and campaign allow us to enhance our educational programming, but now imagine building NEMPAC's capacity for professional performing arts. Picture yourself sitting with friends and neighbors to enjoy an evening of arts in NEMPAC's new intimate community performance space. Now envision NEMPAC investing additional resources to increase and improve our free and discounted professional productions and utilize centrally-located performance space, broadening both our reach and audiences.



# MAKE SPACE FOR ART

In the Fall of 2019, NEMPAC selected Design Build team JJ Welch Contractors and Peterman Architects to help make our vision a reality. The result is an exciting and imaginative design that will propel NEMPAC and the Boston arts community into a brighter future.

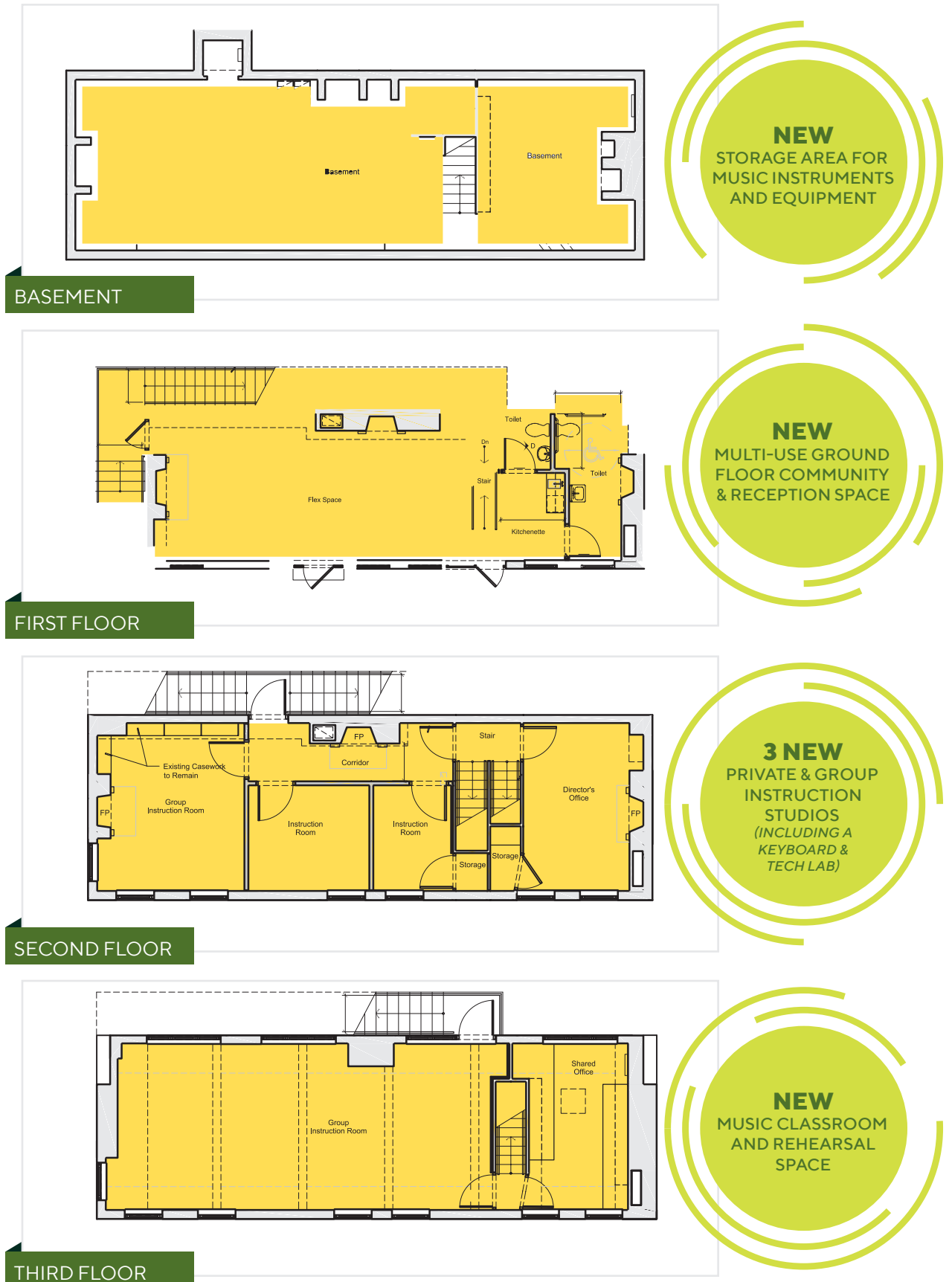

# BRING UP THE LIGHTS

The new 2,200 square foot facility will amplify our impact.



# PLAY YOUR PART

Boston is ready. Gifting us the Tileston Building is a statement from the City of Boston of the value of the arts and its confidence in NEMPAC to continue delivering on our audacious dreams.

The community is ready. Demand for our first-class performances and art education is at an all time high. Our waitlists grow, more and more schools seek partnerships with us, and audiences find themselves desirous of seats to our sold-out shows.

NEMPAC is ready. We have been hungry for growth, planning for growth, engaging our friends in our vision for growth. Our plan is strong, mindfully developed utilizing input from our community and key experts.



**Are YOU ready?**

**Invest in Boston.**

**Invest in your community.**

**Invest in us.**

## TWO WAYS TO PLEDGE TODAY

- 1 Make your donation using the enclosed pledge form and envelope
- 2 Make your donation online to The Next Act campaign:  
[nempacboston.org/TheNextAct](http://nempacboston.org/TheNextAct)

## KEY PLAYERS

Sherri Snow, Executive Director

## BOARD OF DIRECTORS

Dianne Royle, President

Doug Bowen-Flynn, Vice-President

Carl Hall, Treasurer

Mary O'Neill, Clerk

Ramin Khoshatefeh | Anne Occhipinti | Eamon O'Marah

Alex Senchak | Leigh Ann Steele | Andrea Waldstein



NEMPAC  
P.O. Box 130255  
Boston, MA 02113

(617) 227-2270 | [nempacboston.org](http://nempacboston.org)

 @NEMPACBoston

 @NEMPACBoston

 @NEMPACBoston

 North End Music & Performing Arts Center (NEMPAC)

NEMPAC is a 501(c)3 tax-exempt nonprofit organization.  
Donations are tax deductible.